

# Pioneer/ Chana Park



Picnic Shelter with tables

## Needs Assessment Survey Comments:

*Acquisition*                      *None Cited*

*Improvements*                      *Playground*  
    *Sports Court*  
    *Ball Field*

*Trails*                                      *See Trails Plan*

### Recommendations

- Consult & collaborate with Ogle County/ Chana/ BNSF RR/ Utilities Companies to permit playground with security lighting (Seek input from Chana Citizens)
- Consult & collaborate with Ogle County/ Chana/ BNSF RR/ Utilities Companies to permit a small sports court and necessary security lighting (Seek input from Chana Citizens)
- Install circulation path to picnic shelter.
- Install District bike racks, recycling program, kiosk, and signage
- Refer to Capital Improvement Plan and audits for ADA Compliance, Playground Safety, Architectural Maintenance

## Amenities & Improvements

Park Classification	M	
Size (acres)	1.31	
Parking Spaces (on street)	0	
ADA Parking Spaces		
ADA Access	N	
Drinking Fountain		
Bike Racks		
Pavilion		
Gazebo		
Restrooms		
Picnic Shelter	1	
Amphitheater		
Council Ring		
Overlook		
Picnic Tables	2	
Picnic Grills	1	
Benches		
Trail Type		
Trail Length (miles)		
Play (2-5)		
Play (5-12)		
Baseball		
Softball		
Batting Cage		
Football		
Soccer (U6-U10)		
Soccer (U12 & UP)		
Lacrosse		
Basketball		
Volleyball		
Tennis Courts		
Bocce		
Horseshoe		
Fishing		
Fishing Pier/ Docks		
Canoe/ Kayak Launch		
Hunting		
Conservation Area		
Preservation Area		
Historic Site		
Swimming Pool/ Water Play		
Racquetball		
Workout/ Gymnasium		
Classrooms/ Education		

P= Partial, S=Seasonal, Y=Yes, N=No

# Pioneer/ Chana Park Map

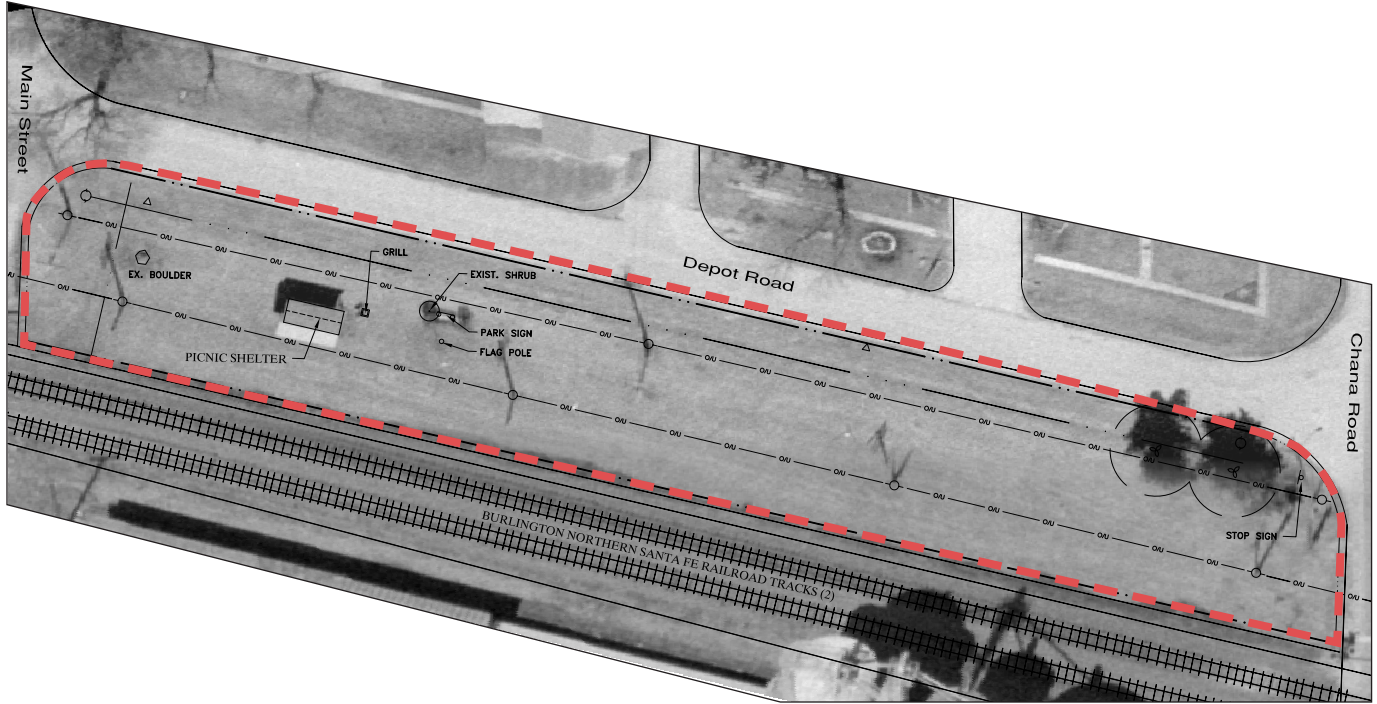

Note - Park Area is formed by Depot Rd R.O.W. and BNSF R.O.W - This is a lease/ Maintenance agreement.

## SCHEDULE OF IMPROVEMENTS

Recommendations	2009	2010	2011	2012	2013	2014
Permit and install playground	25000					
Permit and Install sport court		8000				
Install path to picnic shelter			3500			
Install District signs, bike racks, benches, kiosk, recycling fixtures				12000		

\*All costs are for budgeting purposes only. Adjustments should be made for inflation and market costs.